



Brockworth (6) Aggis Farm, Verwood, BH31 6QD

£650,000

- Family Home
- Multifuel woodburner
- Field views to the rear, offering a tranquil, semi-rural outlook
- Stylish kitchen
- Extensive parking suitable for multiple vehicles

THE PROPERTY

Positioned in a desirable semi-rural location, this beautifully presented five-bedroom detached home sits within the exclusive Aggis Farm development and enjoys open views across surrounding fields.

Accessed via a private gated entrance, the property offers spacious and versatile living accommodation, ideal for modern family life.

To the front, there is extensive parking for multiple vehicles, as well as space for a boat or motorhome, plus access to a large garage. The entrance opens into a welcoming hallway, with a bespoke ash staircase creating a striking focal point.

The kitchen/breakfast room is the heart of the home, fitted with high-quality oak units, quartz work surfaces, and a range of Neff integrated appliances including an oven, combi microwave, warming drawer, fridge/freezer and dishwasher. Karndean flooring adds a modern touch, while French doors open to the rear garden, perfect for entertaining.

The sitting room features a multi-fuel woodburning stove, creating a cosy and inviting space. There's also a separate dining room, a utility room, and a downstairs WC.

Upstairs, the home offers five generously sized bedrooms, with the main bedroom enjoying far-reaching views. Two stylish bathrooms, including one en suite, serve the upper floor.

Set in a peaceful countryside location yet just minutes from Verwood town centre, this property offers the perfect combination of rural living and convenience. With generous indoor space, premium finishes, and beautiful surroundings, this is a rare opportunity not to be missed.

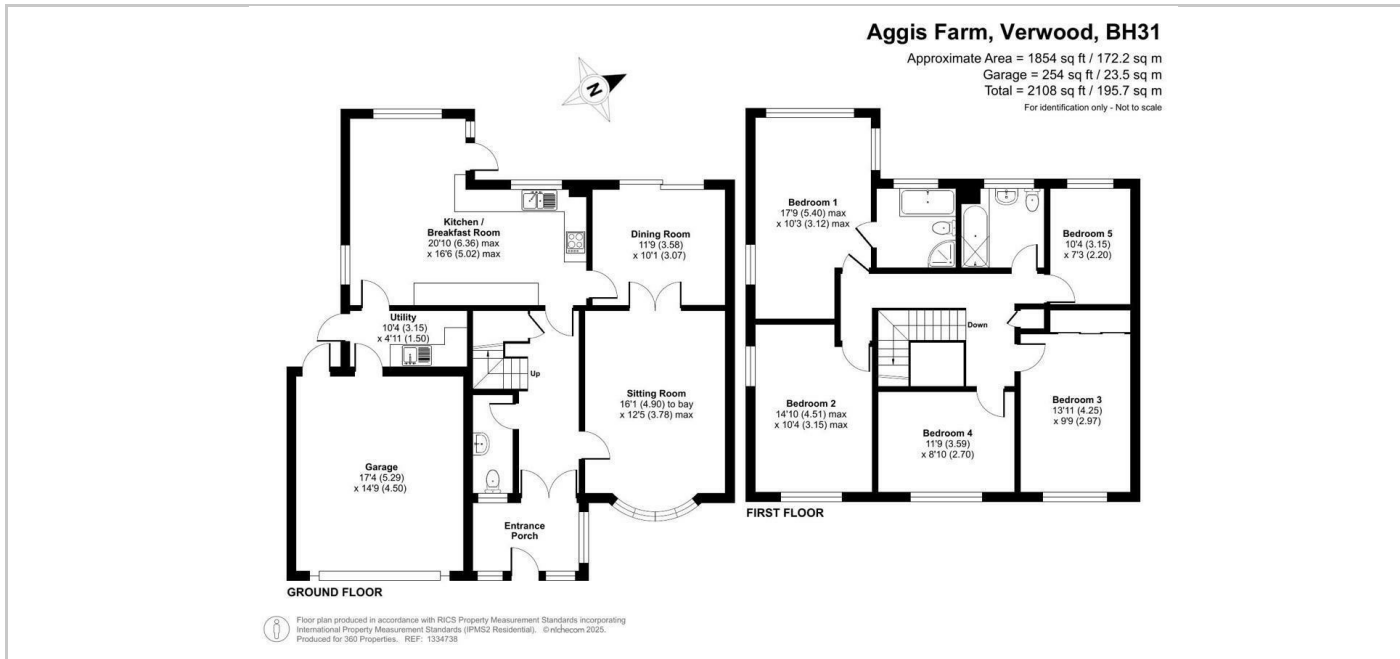

SITUATION

Directions

Unit 1, 28 Blackmoor Rd, Verwood, BH31 6BB
Tel: 01202 177288 Email: Abi@360-properties.co.uk